

2792	
<p>1121X4</p> <p>Ø8 1121 x4</p>	<p>1288X4</p> <p>Ø6x15x6 1288 x4</p>
<p>1033X4</p> <p>Ø8x80 1033 x4</p>	<p>1830X4</p> <p>Ø6x35 1830 x4</p>
<p>1140X4</p> <p>Ø6 1140 x4</p>	<p>1296X4</p> <p>Ø6x15x23 1296 x4</p>
<p>1713X4</p> <p>Ø6x55 1713 x4</p>	<p>1422X4</p> <p>Ø5x80 1422 x4</p>
<p>1120X16</p> <p>Ø6 1120 x16</p>	<p>1837.0X4</p> <p>Ø6x70 1837.0 x4</p>
<p>2343X1</p> <p>2343 x1</p>	<p>1726X2</p> <p>Ø6x35 1726 x2</p>
<p>2303X2</p> <p>2303 x2</p>	<p>2204X2</p> <p>2204 x2</p>
<p>1450X2</p> <p>Ø5x20 1450 x2</p>	<p>1810.0X4</p> <p>Ø5x25 1810.0 x4</p>
<p>1270X2</p> <p>Ø6x15x5 1270 x2</p>	<p>1705X2</p> <p>Ø6x16 1705 x2</p>

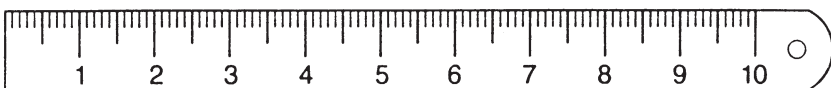



Montage de toutes les phases à 2 personnes. - Assembly during all stages with 2 people. - Für die Montage sind 2 Personen von Vorteil. - Montage van alle fasen met 2 personen. - Il montaggio richiede 2 persone in tutte le fasi. - Montaje de todas las fases a 2 personas. - Montagem de todas as fases com 2 pessoas - Συναρμολόγηση όλων των φάσεων με 2 άτομα - Minden összeszerelési szakaszt 2 személynek kell elvégezni - Montaż wszystkich etapów przez 2 osoby - Toate etapele de montare trebuie realizate de către 2 persoane - Všechny montážní kroky musejí provádět 2 osoby. - Сборка на всех стадиях должна производиться 2 лицами.



Laisser du jeu - Leave a little play - Es ist ein Spiel zu lassen - Laat wat speling - Lasciare del gioco - Dejar holgura - Deixar folga - Λασκάρετε - Hagyjon egy kis játékot - Pozostaw przerwę - Abandonarea/Cedarea jocului - Nechejte dostatečnou vůli. - Оставить зазор





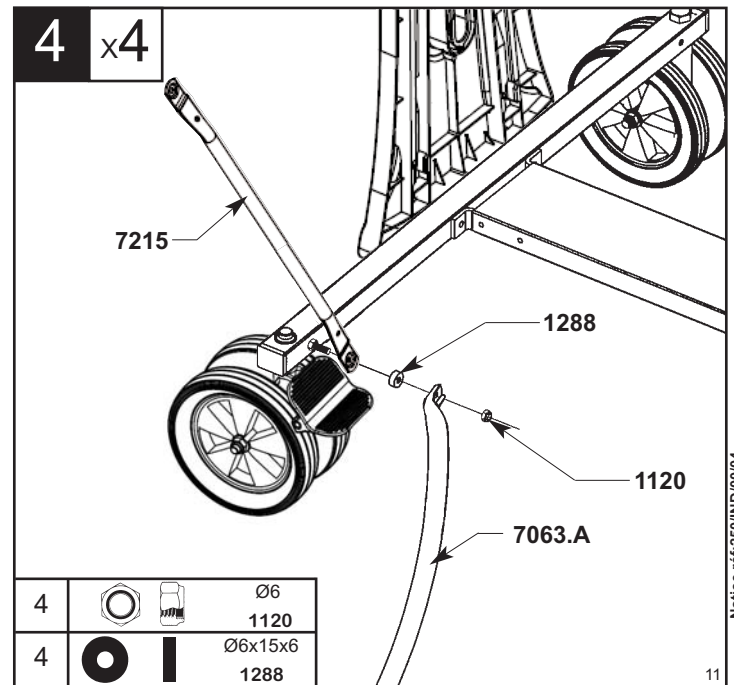
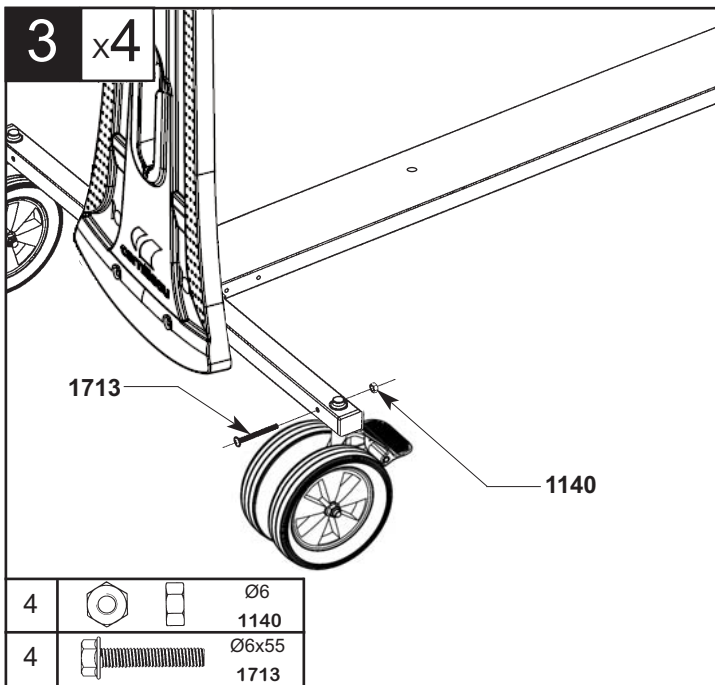
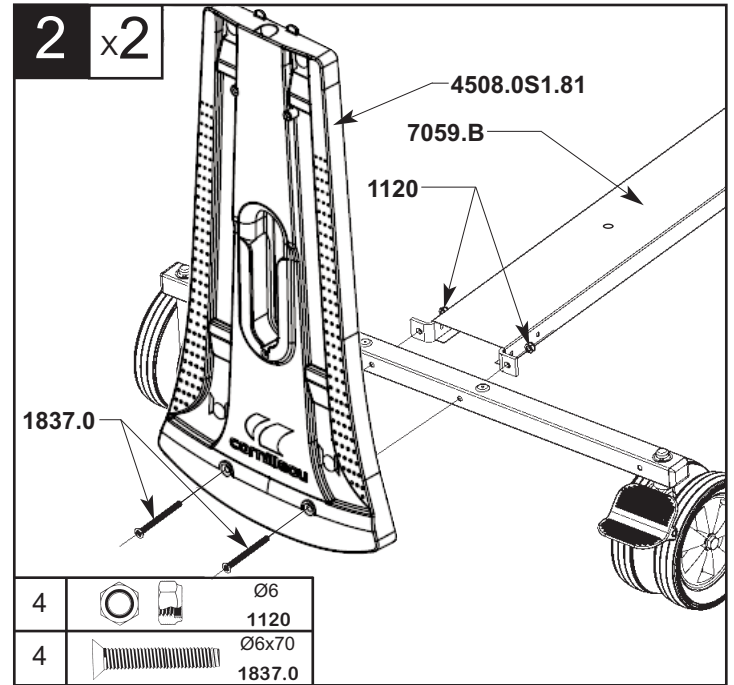
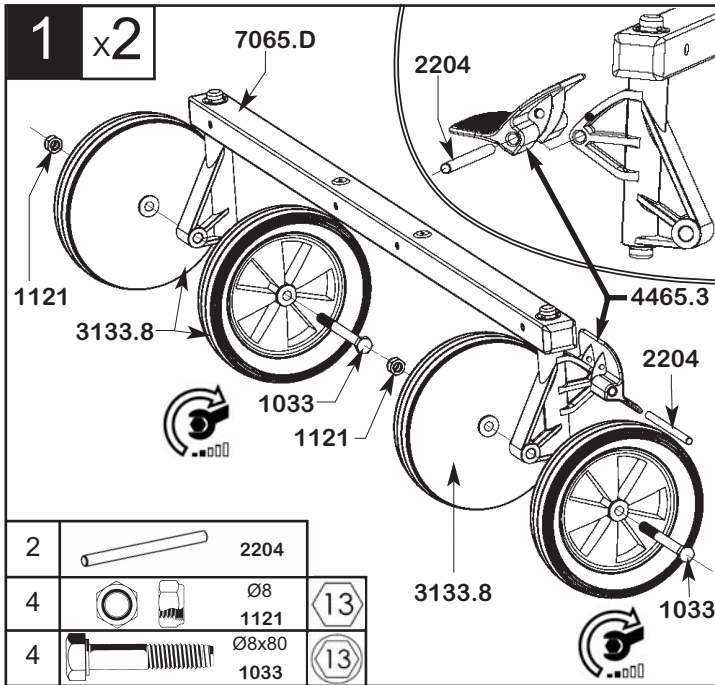

Serrer - Tighten - Pressen - Aandraaien - Stringere - Apretar - Aperte - ελέγchw αυστηρά, καταστέλλω - Meg kell - Jedna śruba - Stoarceți - Jeden šroub - Сожмите

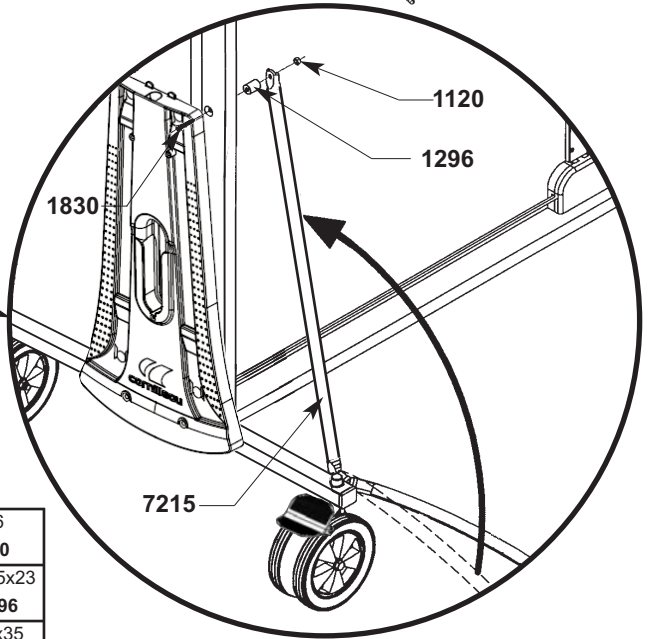
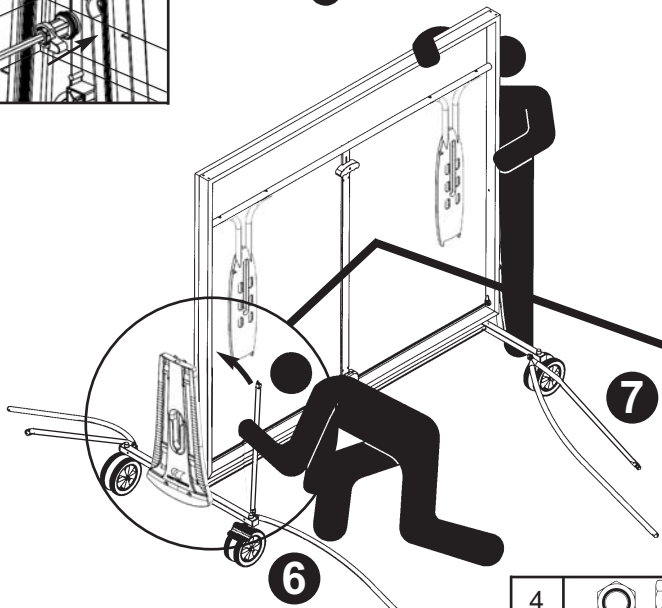
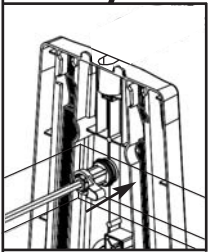
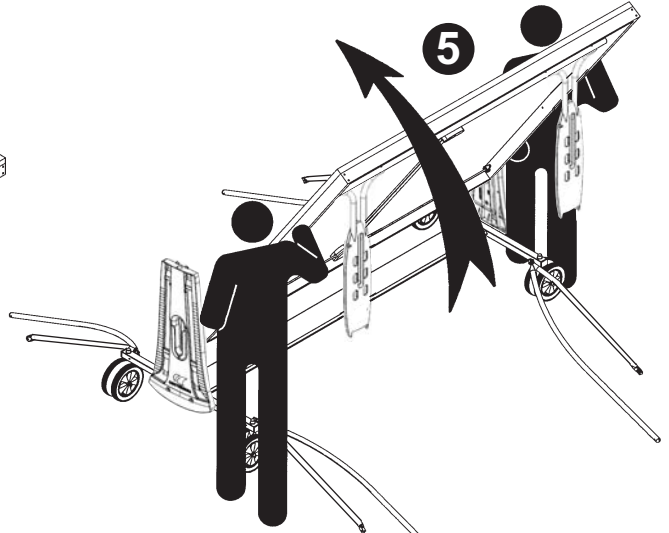
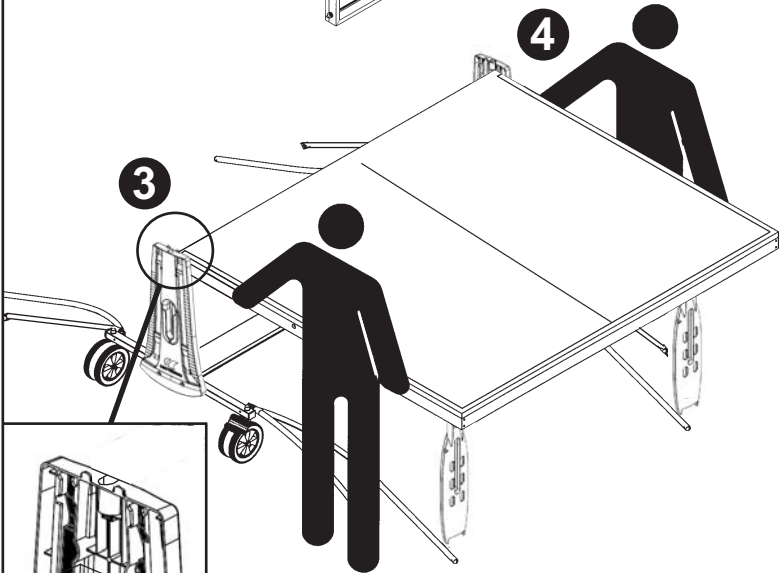
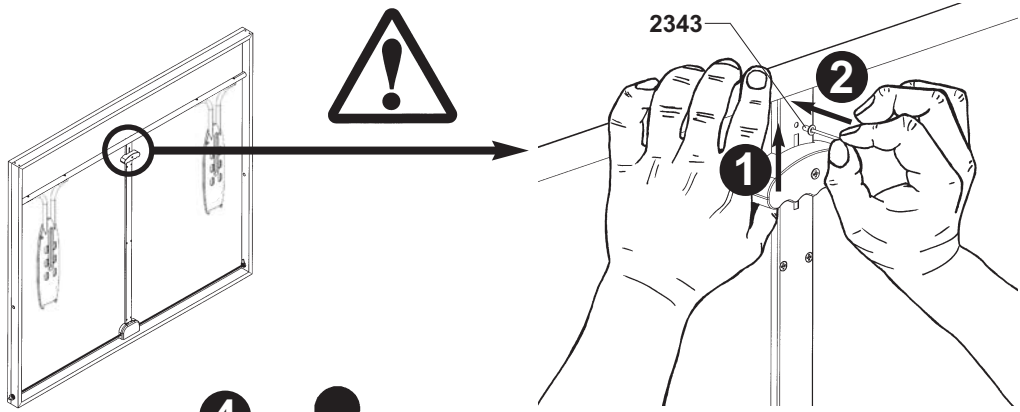
x2 Repeter l'opération (x) fois - Repeat operation (x) times - Wiederholen Sie diesen Vorgang (x) mal - deze handeling (x) maal herhalen - Operazione da ripetere (x) volte - Repetir la operacion (x) veces - Repetir a operação (x) vezes - Επαναλαμβάνετε τη πράξη (x) φορές - Ismétélje meg a műveletet (x) alkalommal - Powtórz czynność (x) razy - Repetați operațiunea de (x) ori - Operaci (x) krát opakujte. - Повторить операцию (x) раз



5 x2



4			Ø6 1120
4			Ø6x15x23 1296
4			Ø6x35 1830

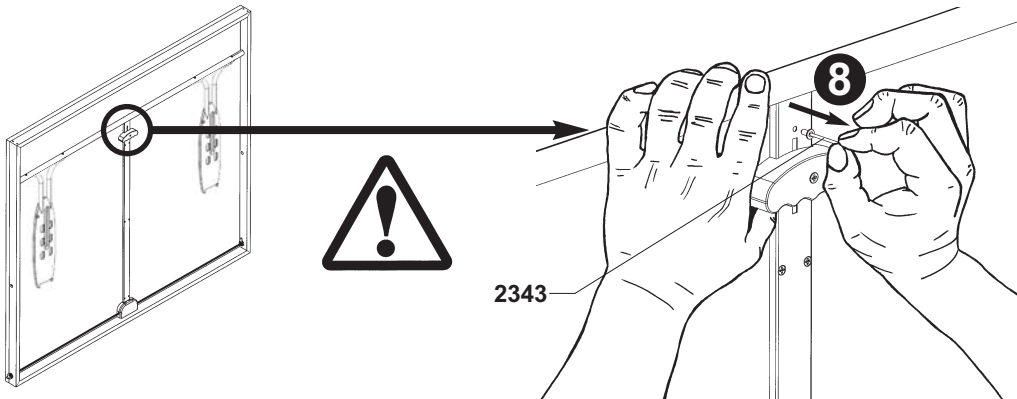

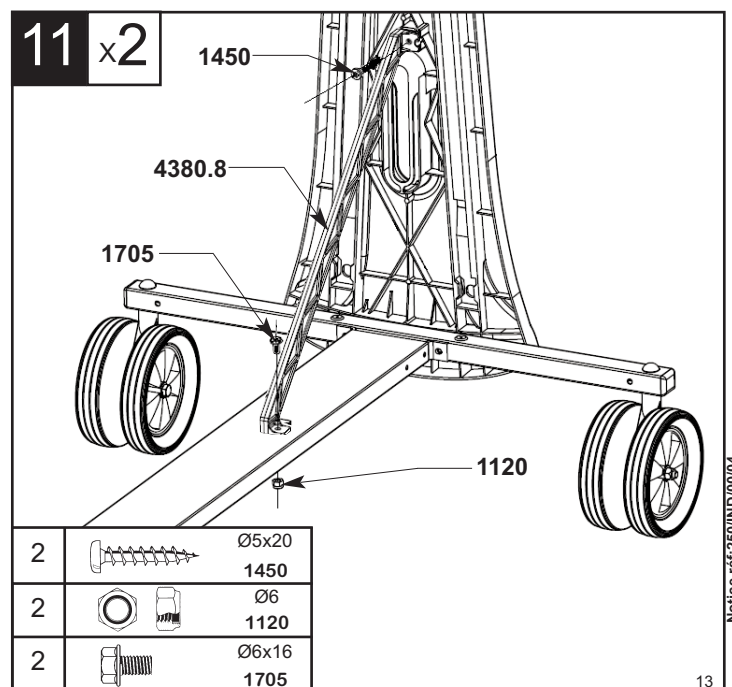
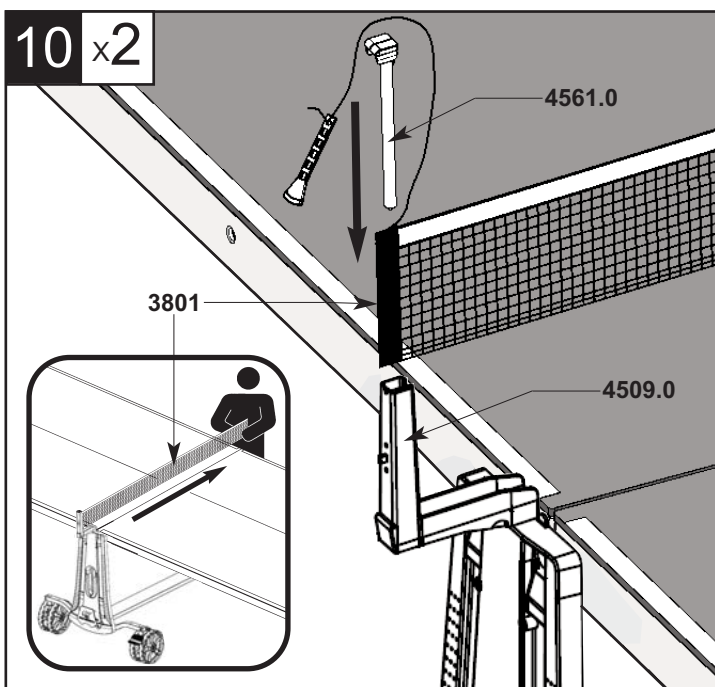
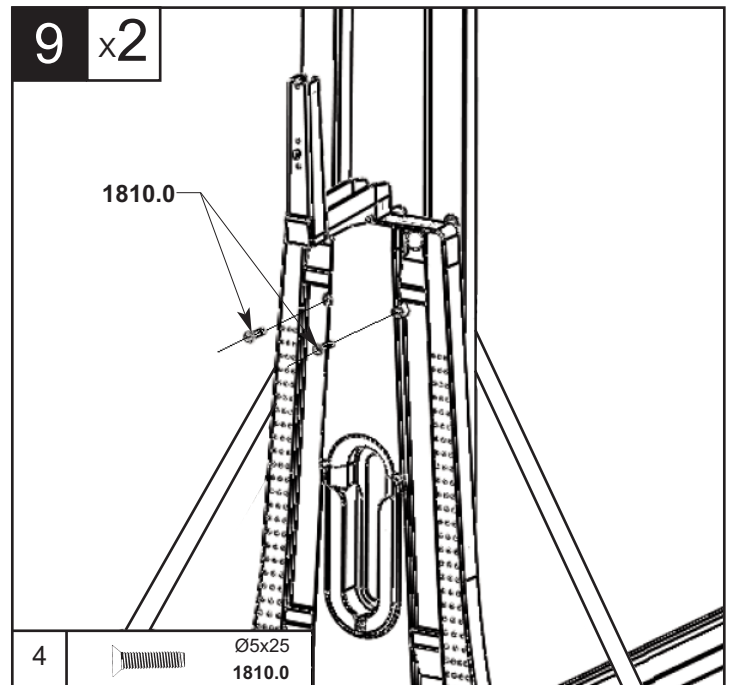
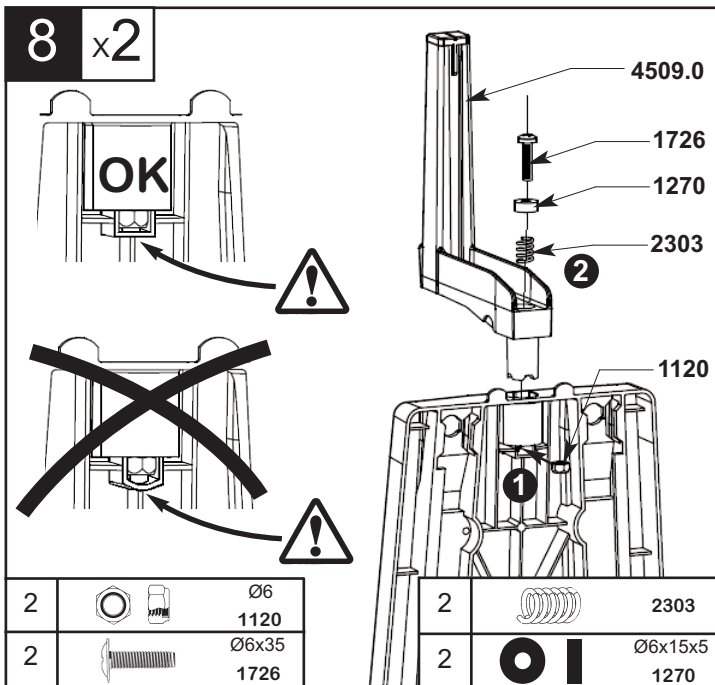
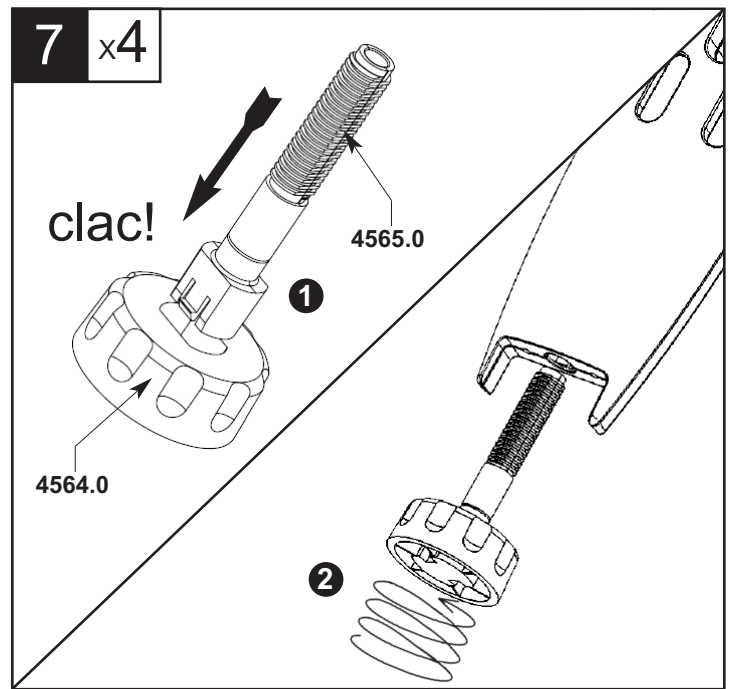
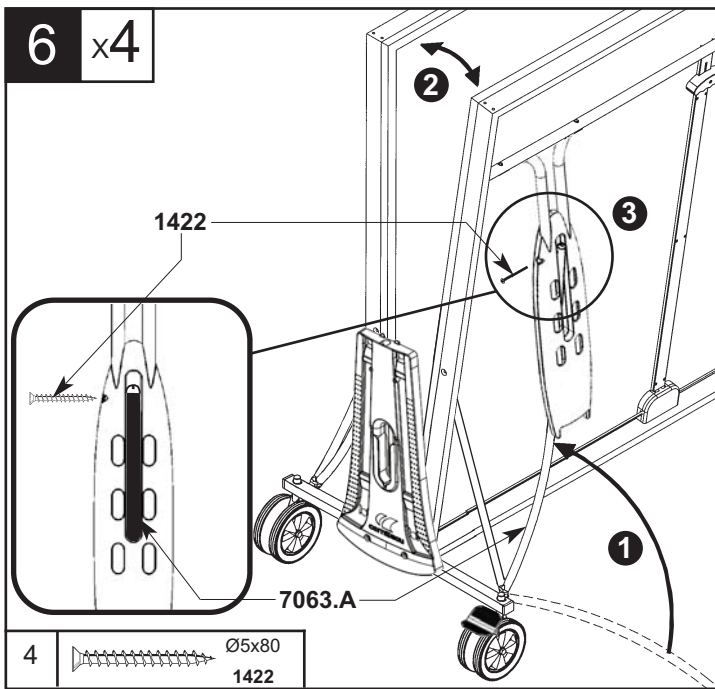

Remise en place du système de verrouillage en cas de dysfonctionnement - Repair of the locking system in case of malfunction - Öffnung des Verriegelungssystems für Reparatur - Reparatie (aleen indien) - Rimessa in ordine del sistema di chiusura in caso di malfunzionamento - ReparaciOn (solamente si es necesario) - Colocação em posição do sistema de bloqueio no caso de disfunção - Ξαναθέτετε στη θέση το σύστημα κλειδώματος σε περίπτωση δυσλειτουργίας - A zárrendszer helyreállítása működési hiba esetén - Przywrócenie systemu blokady w przypadku niewłaściwego działania - Reglarea sistemului de blocare în caz de disfuncție - Nasazení zajišťovacího systému v případě špatného fungování stolu - Установить систему блокировки в случае функционального сбоя.

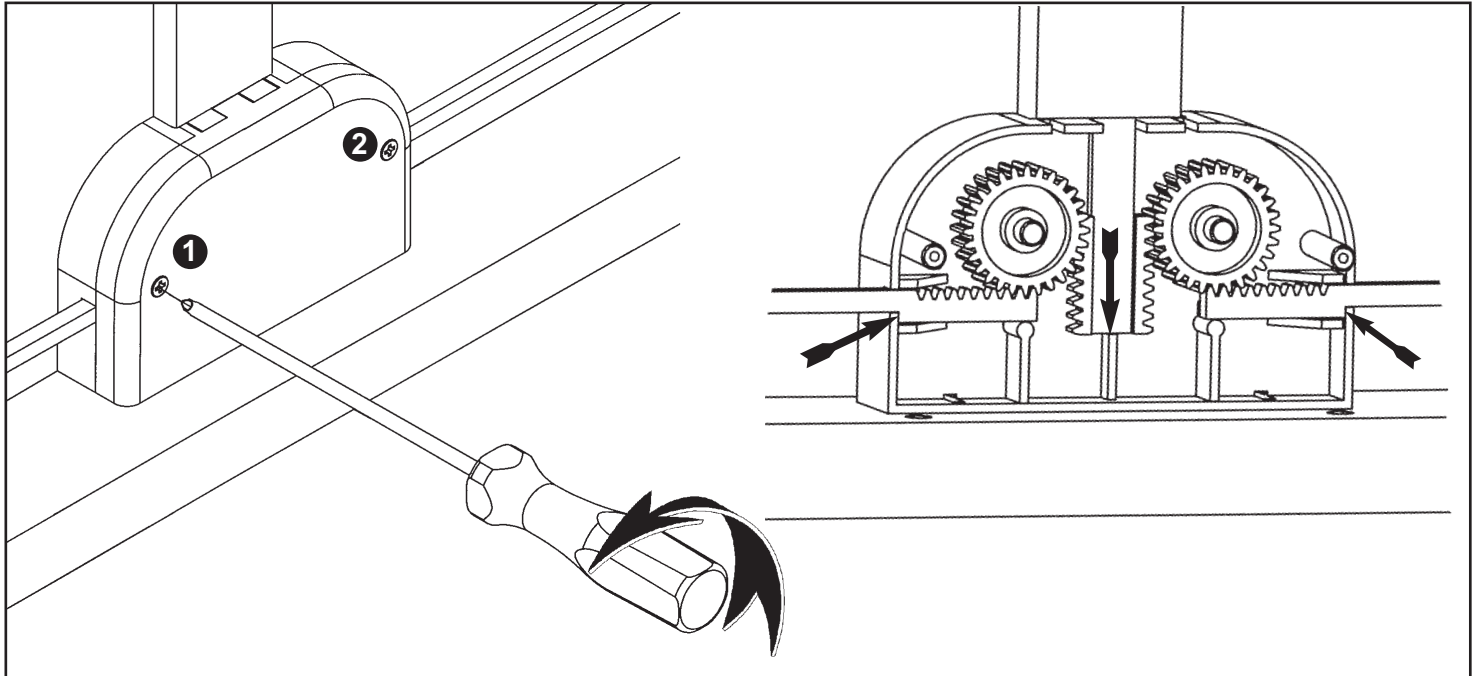

2792

2792	
1121x1 08 1121 x1/4	1288x1 08x15x8 1288 x1/4
1033x1 08x10 1033 x1/4	1830x1 08x25 1830 x1/4
1140x1 08 1140 x1/4	1296x1 08x15x23 1296 x1/4
1713x1 08x55 1713 x1/4	1422x1 08x50 1422 x1/4
1120x16 08 1120 x16	1837x1 08x70 1837 x1/4
2343x1 08x35 1726 x1/2	1726x2 08x35 1726 x1/2
2303x2 08x35 1450 x1/2	2204x2 08x35 1830 x1/4
1270x2 08x15x5 1270 x1/2	1708x2 08x18 1708 x1/2

2831

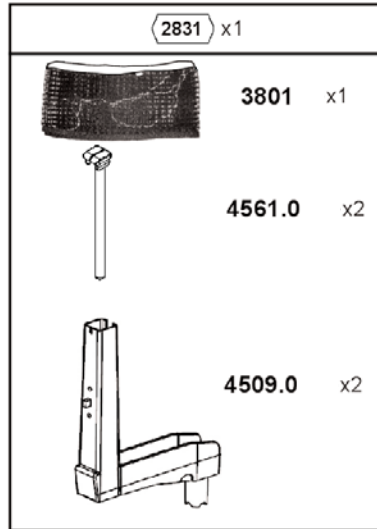

9586

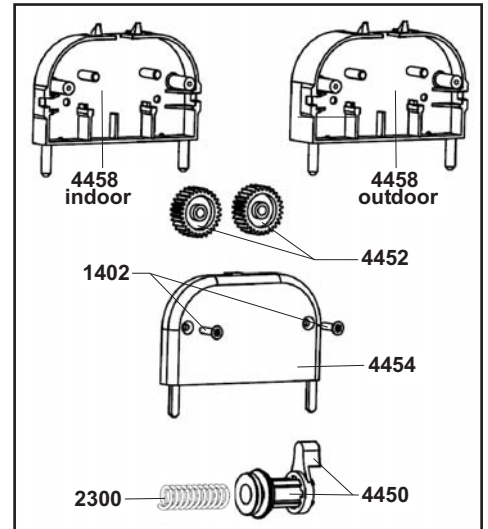

93133

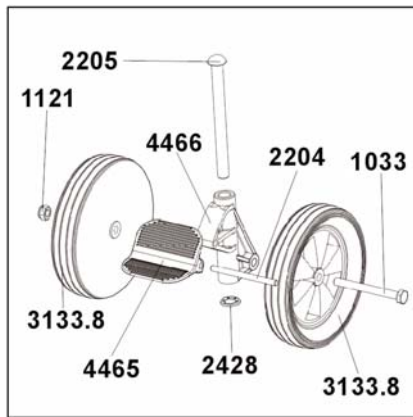

3233.8

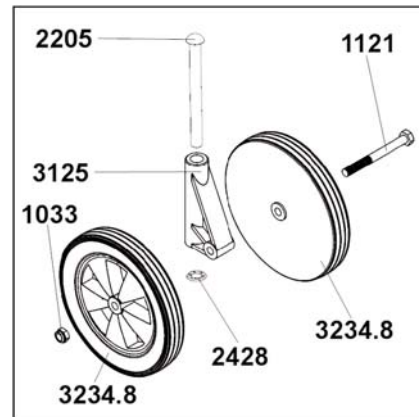

Pour toutes vos pièces détachées
For all your spare parts

www.cornilleau-services.com

Nomenclature des pièces détachées - Spare parts list

INDOOR BLEU
PL132650/1

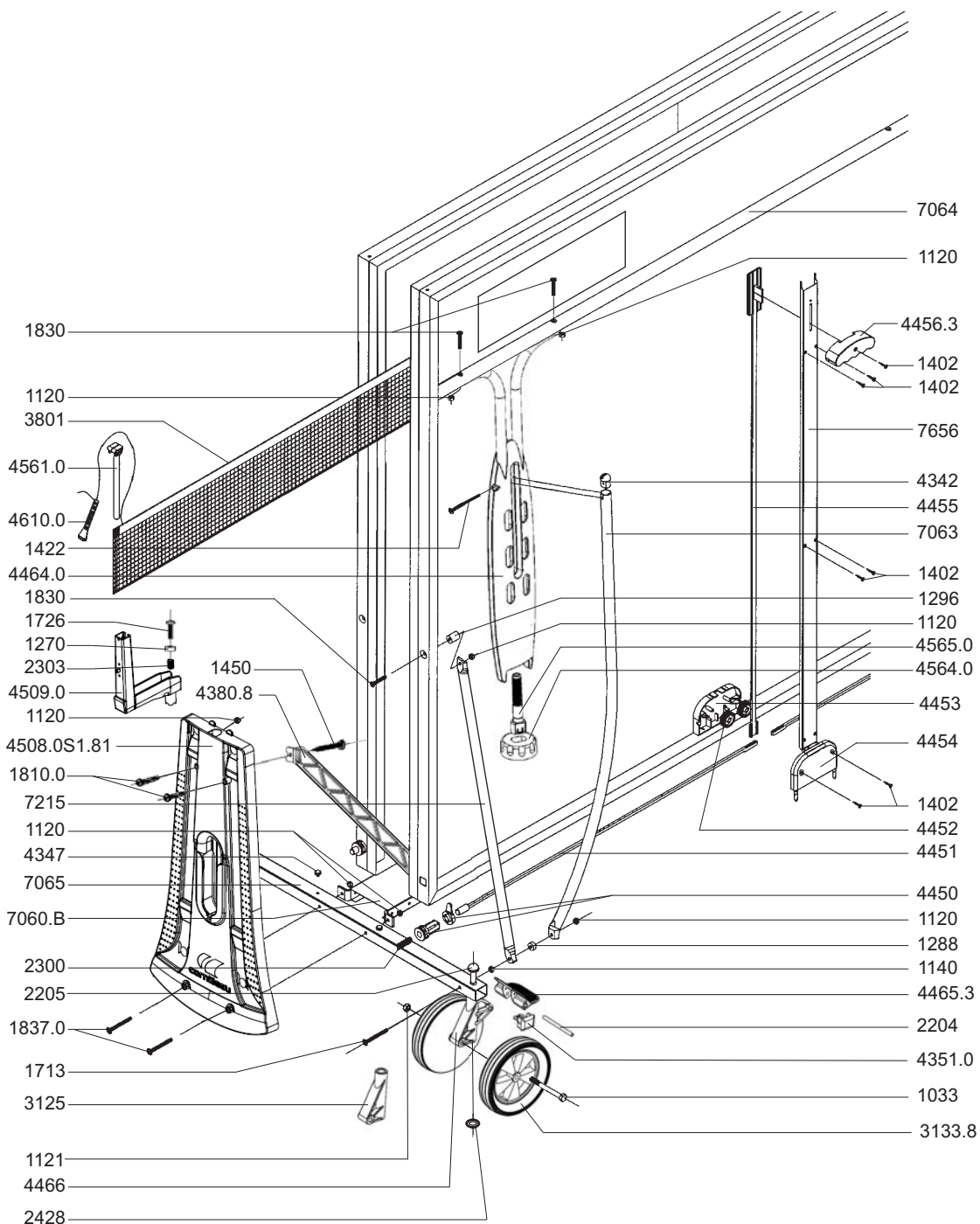
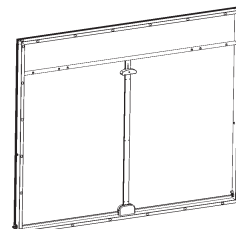

	Ø8x80 1033
	Ø6 1140
	Ø6 1120
	Ø8 1121
	Ø6x15x5 1270
	Ø6x15x6 1288
	Ø6x15x23 1296
	Ø4x20 1402
	Ø5x80 1422
	Ø5x20 1450
	Ø6x35 1726
	Ø6x16 1705
	Ø6x55 1713
	Ø6x35 1830
	Ø6x70 1837.0
	2300
	2303

Pour toutes vos pièces détachées
For all your spare parts